

CONDITION OF APPROVAL  
 PLANNING BOARD APPROVAL  
 TOWN OF LINCOLNVILLE ~ WALDO COUNTY  
 NAME \_\_\_\_\_  
 DATE \_\_\_\_\_

VICTORIA LANNING  
 2369307

RECORD OWNER  
 WAYNE B. LANNING  
 170447

RECORD OWNER  
 MIKE & CORAL  
 COOMBS  
 953301

NOW OR FORMERLY  
 CHAS. A. SCOPPA JR.  
 7091796

NOW OR FORMERLY  
 EDITH TEGEDER  
 12901221

NOW OR FORMERLY  
 EDITH TEGEDER  
 12901221

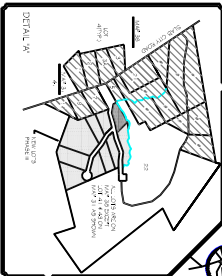
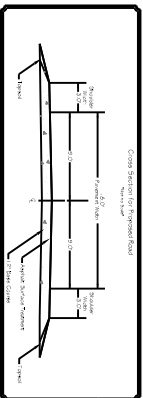

This survey conforms to the State Board of Registration for Land Surveyors. There is no other representation or warranty by the surveyor in this respect.

Surveyor's License No. 16,712  
 Date: \_\_\_\_\_

**SURVEY NOTES:**

- 1.) SOI'S TEST PINS SHOWN ON THIS PLAN WERE DONE BY JAMES WARELL, SOILS EVALUATOR.
- 2.) UTILITIES WERE DETECTED BY ADAM HARRISTROCK OF KLEINSCHMIDT ENGINEERING.
- 3.) THE PROPERTY IS IN A GENERAL LAND USE DISTRICT.
- 4.) THE PROPERTY IS IN A FLOOD HAZARD ZONE. SEE 230172 CO. GEN. PLAN. (NOT RECORDED). THERE IS NO SPECIAL FLOOD HAZARD AREA.
- 5.) ALL FUTURE CONSTRUCTION ON THE SITE SHALL FOLLOW MANAGEMENT PRACTICES OF THE DEPARTMENT OF ENVIRONMENTAL PROTECTION'S BEST MANAGEMENT PRACTICES.
- 6.) A 5' WIDE DITCH SHALL RUN ALONG THE WEST BOUNDARY PARALLEL TO A REFERENCED DRIVE CROSSING WEST AREA TO THE SOUTHERLY SECTION OF LOT # 13.

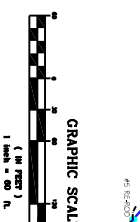

FORMERLY  
 SHELBY CRAWFORD  
 0169305

Preliminary Phase III  
 Springbrook Subdivision  
 of  
 Wayne B. Lanning  
 in  
 Lincolnville, Waldo County  
 Slab City Road

**LEGEND**

- #5 RE-ROD (TO BE SET)
- #5 RE-ROD (P/R/O SURVEY)
- PROPERTY PIN (ROUND TP?)
- BROOK
- DITCH
- TEST PIT
- UTILITY POLE
- MAP NUMBER / LOT NUMBER
- WET
- NATURAL DRAINAGE FLOW (DIRECTION TO BE INDICATED AS NECESSARY)
- GRAVEL ROAD

**PLAN REFERENCES:**

- 1.) REFERENCE BOUNDARY SURVEY FOR ALAN WILLIAMS BY CARL LAND SURVEYERS DATED APRIL, 1982.
- 2.) REFERENCE SPRINGBROOK SUBDIVISION PHASE I PER WALTER LANNING BY LANSBROCK LAND SURVEYS DATED OCT. 1, 1987 RECORDED IN THE WALDO COUNTY REGISTER MAP # 020021.
- 3.) REFERENCE SPRINGBROOK SUBDIVISION PHASE II PER WALTER LANNING BY LANSBROCK LAND SURVEYS DATED OCT. 1, 1987 RECORDED IN THE WALDO COUNTY REGISTER MAP # 020022.
- 4.) REFERENCE SPRINGBROOK SUBDIVISION PHASE III PER WALTER LANNING BY LANSBROCK LAND SURVEYS DATED OCT. 1, 1989 RECORDED IN THE WALDO COUNTY REGISTER MAP # 020023.

